

Inductance Range: 0.78μH~1000μH
Temperature Range: -40℃~+125℃

PDBW1680-Series

DIMENSIONS(mm)

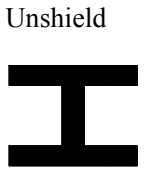
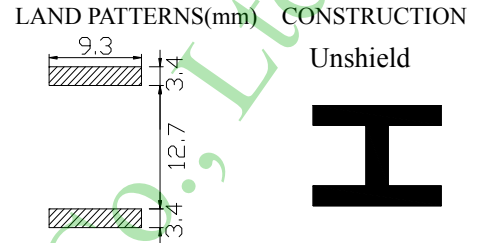
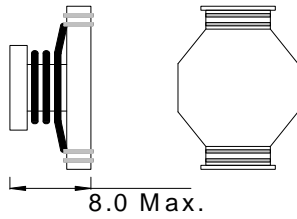
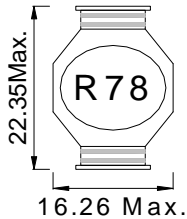

FEATURES:

- ★Quantity / Reel: 350pcs
- ★High current & low DCR, Elliptic 16.26mm*22.35mm, Height 7.5mm Type.
- ★The use of carrier tape package for SMT reflow soldering process
- ★Widely use in DC-DC converter/LCD TV/Notebook/ PDA /Digital camera/DVD etc.
- ★Design to customer requirement

RoHS Compliant(SGS Certified Result)				
Pb	Cd	Cr+6	PBBs	PBDEs
<1000ppm	ND	ND	ND	ND

Electrical Characteristics:

Part Number	Test Condition	Inductance (μH)	Tolerance (%)	D.C.R(mΩ) Max.	Rated Current	
					Isat(A)	Irms(A)
PDBW1680-R78N	1KHz/1.0V	0.78	±30	3.00	30.00	15.00
PDBW1680-1R5M	1KHz/1.0V	1.5	±20	4.00	25.00	15.00
PDBW1680-2R2M	1KHz/1.0V	2.2	±20	6.00	20.00	12.00
PDBW1680-3R3M	1KHz/1.0V	3.3	±20	9.00	17.00	10.00
PDBW1680-3R9M	1KHz/1.0V	3.9	±20	10.0	15.00	9.00
PDBW1680-4R7M	1KHz/1.0V	4.7	±20	14.0	13.00	8.40
PDBW1680-6R0M	1KHz/1.0V	6.0	±20	17.0	12.00	7.50
PDBW1680-7R8M	1KHz/1.0V	7.8	±20	18.0	11.00	7.50
PDBW1680-100M	1KHz/1.0V	10	±20	26.0	10.00	6.00
PDBW1680-150M	1KHz/1.0V	15	±20	32.0	8.00	4.40
PDBW1680-220M	1KHz/1.0V	22	±20	47.0	7.00	3.50
PDBW1680-330M	1KHz/1.0V	33	±20	66.0	5.50	3.00
PDBW1680-470M	1KHz/1.0V	47	±20	86.0	4.50	2.60
PDBW1680-680M	1KHz/1.0V	68	±20	130	3.50	2.30
PDBW1680-101M	1KHz/1.0V	100	±20	190	3.00	1.80
PDBW1680-151M	1KHz/1.0V	150	±20	250	2.60	1.50
PDBW1680-221M	1KHz/1.0V	220	±20	380	2.40	1.20
PDBW1680-331M	1KHz/1.0V	330	±20	560	1.90	1.00
PDBW1680-471M	1KHz/1.0V	470	±20	850	1.40	0.82
PDBW1680-681M	1KHz/1.0V	680	±20	1100	1.20	0.72
PDBW1680-102M	1KHz/1.0V	1000	±20	1800	1.00	0.56

- 1、 Inductance is measured with a LCR meter:HP4284A & 3532-50 or equivalent.
- 2、 D.C .R is measured with a Digital Multimeter TH2512B or equivalent.
- 3、 The Isat is the current at which the inductance decreases by 10% from the initial value
- 4、 The Irms by Stand-Type is the current at which the temperature rise is ΔT≤40℃, whichever (Ta=20℃)